

 **DASHWOOD**[®]
since 1928



Trinity[®] Series
Vinyl Windows

PROUDLY
CANADIAN

OWNED &
MANUFACTURED



DASHWOOD® Industries has been manufacturing high quality building products, windows and doors since 1928. From those early years until the present day our commitment to provide the very best quality, selection and service to our customers has not wavered.

When you select Dashwood, in addition to beautiful and superior performing Canadian manufactured windows and doors, you get the peace of mind that comes from dealing with a company whose essential values and culture have been formed by over 80 years of dedication to total customer satisfaction. Trust Dashwood, our people and our products, to meet your expectations of performance and value every time.

TRINITY[®] VINYL WINDOWS

The Dashwood tradition of offering superior style, performance and value continues with our newest family of Canadian designed and manufactured vinyl windows: the Trinity[®] Series.

Beauty and style combined with performance and durability; Trinity[®] windows utilize heavier gauge PVC extrusions with fusion welded corners for strength and stability. Specially designed air chambers in the frame and sash combine with premium high-performance dual-pane or triple-pane glass options to provide maximum energy efficiency and year-round comfort. Maintenance-free profiles embody the style and elegance of traditional millwork craftsmanship for an appearance that is uncommon among vinyl windows.

Trinity[®] Series windows are made to order in a wide range of window styles and shapes for insert or full-frame installation. Options and accessories allow customization to suit most any replacement, renovation or new-construction application, all supported by one of the most comprehensive warranties in the industry.

Make a wise investment in style, performance and value: contact a Dashwood dealer to learn more about how Trinity[®] windows can make your home better.





Energy efficient windows are an important element of any new home and a critical consideration for older homes undergoing renovation or window replacement. The selection of proper windows will enhance your overall year round comfort levels while also saving you money by reducing energy and maintenance costs. Dashwood Trinity® windows are available with options to suit a variety of thermal performance requirements and building code requirements. Performance ratings are supported by independent certification and product identification.

Windows and patio doors are now included on the growing list of products that qualify for the Energy Star® international symbol for energy efficiency. All Energy Star qualified windows and sliding glass patio doors have been certified by an accredited independent agency for quality and performance. Dashwood is committed to providing windows that are certified to meet Energy Star standards and offers Low-E glass options to meet or exceed the required performance levels in all Canadian zones.

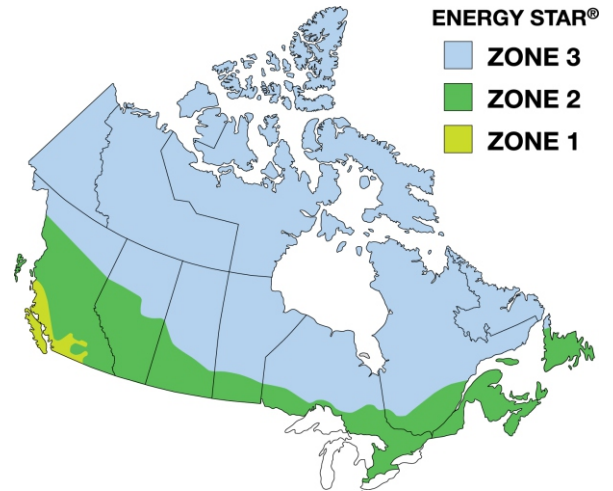

Trinity® Series Performance Ratings

Window Type	Glass Type	NRCan Ratings			
		NRCan U-Value (W/m ² °C)	SHGC	ER	Zone
Low Profile Picture	LoE 180	1.53	0.60	41	1,2,3
Fixed Casement	LoE 180	1.49	0.46	34	1,2,3
Casement	LoE 180	1.52	0.46	33	1,2
Awning	LoE 180	1.53	0.46	33	1,2
Gliding	LoE 180	1.66	0.52	33	1,2
Double Hung	LoE 180	1.45	0.52	33	1,2
Low Profile Picture	LoE 180 Triple Pane	0.88	0.49	49	1,2,3
Fixed Casement	LoE 180 Triple Pane	0.99	0.38	40	1,2,3
Casement	LoE 180 Triple Pane	1.02	0.37	39	1,2,3
Awning	LoE 180 Triple Pane	1.02	0.37	39	1,2,3
Gliding	LoE 180 Triple Pane	1.48	0.44	32	1,2
Double Hung	LoE 180 Triple Pane	1.40	0.44	34	1,2,3
Low Profile Picture	LoE 272	1.48	0.36	28	1
Fixed Casement	LoE 272	1.46	0.28	24	1
Casement	LoE 272	1.48	0.28	23	1
Awning	LoE 272	1.50	0.28	23	1
Gliding	LoE 272	1.62	0.32	22	0
Double Hung	LoE 272	1.60	0.32	22	1
Low Profile Picture	LoE 366	1.45	0.24	22	1
Fixed Casement	LoE 366	1.43	0.19	20	1
Casement	LoE 366	1.45	0.19	19	1
Awning	LoE 366	1.47	0.19	19	1
Gliding	LoE 366	1.58	0.21	17	1
Double Hung	LoE 366	1.57	0.21	17	1

U-Value: overall heat-transfer coefficient, describes how a product conducts heat. The lower the U-value the better the insulating value.

SHGC: Solar Heat Gain Coefficient, measures the amount of solar heat gain through the glass on a scale of 0-1.0. The higher the number the higher the solar heat gain. Solar heat can provide free heat during winter but can lead to overheating in summer. Consideration should be given to factors such as regional climate, the direction that windows face, shading and other conditions when selecting glass type to balance solar heat gain for year round comfort and efficiency.

ER: Energy Rating, calculated using a formula that considers a product's U-value with potential solar heat gain and air tightness. The higher the ER, the more energy efficient the product theoretically is.

Certification and testing carried out by: Intertek Testing Services NA Ltd. | 3210 American Drive, Mississauga, Ontario L4V 1B3 | 905-678-7820
For additional performance ratings contact your Dashwood Dealer.

Trinity windows are tested and certified to meet or exceed CSA A-440-00 standards.

ENVIRONMENTAL CONSCIOUSNESS AND SUSTAINABILITY

Dashwood's commitment to the environment is evident in our energy-efficient products and responsible manufacturing processes. A member of the community since 1928, our corporate culture reflects our dedication to improving the quality of our products, processes and the environment.

Energy Efficient Products and Materials

Vinyl is an energy efficient, affordable and versatile material that is preferred for building materials due to its durability and superior weathering properties. Composed of natural ingredients, chlorine and ethylene, vinyl plays a vital role in building an energy efficient and sustainable environment. Vinyl products can last a lifetime and vinyl windows with insulating glass will provide many years of energy saving thermal performance. Vinyl components and glass are also fully recyclable.

Environmental Awareness: Recycling and Sustainable Practices

Providing Energy Star certified energy efficient windows for both new construction and replacement markets is only a part of our commitment. Dashwood Industries is dedicated to energy efficiency and sustainability every day through a number of initiatives including:

- Vinyl material waste recycling
- Cardboard and metal recycling
- Scrap material repurposing programs
- Use of returnable/reusable containers
- Freight consolidation practices for fuel consumption reductions
- Access to remanufactured and FSC certified wood sources
- Low VOC water-borne painting processes
- Facility energy conservation and recycling programs



Casement



Casement style windows feature a full sized operating sash hinged on the side to open outward to the right or left. Also available in stationary units with matching design and sightlines. Trinity's profiled sash design lends a classic look to this popular contemporary style.

(1) Truth Encore[®] Hardware – standard with an attractive folding handle that neatly nests into the operator cover and will not interfere with interior window coverings. Requires 33% less effort to open and close than standard crank-out hardware while providing contemporary style. Available in 25 traditional and 8 decorative finishes.

(2) Multi-Point Locking System with Triple Weatherseal – Multipoint locking is easily engaged with single ergonomic handle; combines with Trinity's triple weather seal system for air tight, water tight security.

(3) Wide Surround Screen Frame – overlaps the window frame for a clean, no-seam appearance. Concealed spring-loaded fasteners allow for quick and easy screen removal.

Awning



Awning style windows feature full sized operating sash hinged at the top to open outward from the bottom. Allows for ventilation in a variety of weather conditions. The awning shares sash and frame style with the casement and is also offered in complementary stationary units.

(1) Truth Encore[®] Hardware – standard with an attractive folding handle that neatly nests into the operator cover and will not interfere with interior window coverings. Requires 33% less effort to open and close than standard crank-out hardware while providing contemporary style. Available in 25 traditional and 8 decorative finishes.

(2) Side Locking with Triple Weatherseal – twin locks mounted one on each side are engaged with ergonomic lever handles; combine with Trinity's triple weather seal system for air tight, water tight security.

(3) Wide Surround Screen Frame – overlaps the window frame for a clean, no-seam appearance. Concealed spring-loaded fasteners allow for quick and easy screen removal.

Gliding



Gliding window styles feature sash that slide left and right. Operating sashes swing inward for easy cleaning. Gliding windows are offered in 2-panel configurations where both sash move or 3-panel configuration with stationary centre sash.

(1) Cam-Action Lock and Keeper – combine with interlocking meeting rail and weather sealing system for weather-tight security. Available white or black finish.

(2) Recessed Swing Latches – finger-activated latch release locks allow sash to swing inwards for cleaning; recessed for a clean interior appearance

Double Hung Tilt



Traditional Double-Hung style windows feature upper and lower sashes that slide up and down for ventilation. Both sashes tilt inward for easy cleaning.

(1) Cam-Action Lock and Keeper – work in conjunction with interlocking meeting rail, pocket sill design and weather sealing system for weather-tight security. Available white or black finish.

(2) Recessed Tilt Latches – finger-activated latch release locks allow sash to swing inwards for cleaning; recessed for a clean interior appearance.

(3) Constant Force Coil Balance System – concealed within the frame, each coil balance is gauged for the specific sash size and weight; requires less effort to raise and lower the sash compared to other spiral balance systems.



Architectural Shapes and Picture Windows

Trinity picture windows have a narrow frame design with no sash that allows for maximum glass area and unobstructed views. Made to order sizes in rectangular, geometric or curved shapes are perfect for special replacement or renovation requirements.



LoE Glass

Dashwood Trinity® windows feature insulating glass manufactured by Cardinal Glass Industries, a leader in the development and manufacture of advanced residential glass for windows and doors.



Cardinal LoE-180™

- standard on all Trinity® windows
- best total performance for colder climates
- lets the winter sun's heat enter the room while preventing room heat from escaping to the outside cold



Cardinal LoE2-272®

- year round performance
- in winter reflects heat back into the room
- in summer reflects sun's heat and damaging UV rays
- balances summer cooling and winter heating demands



Cardinal LoE3-366®

- 3 layers of Low E coating
- high solar control without a dark tint appearance
- balanced performance for year-round comfort



Cardinal LoE2-240®

- perfect choice for high solar glare locations
- blocks solar heat gain maintaining cooler indoor glass temperatures
- tinted glass that reduces the visible light by 60%

Insect Screens

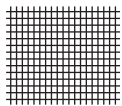

Standard – charcoal colour 18 x 16 fibreglass mesh with wide surround aluminum frame and concealed fasteners.

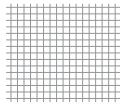

Optional – Clearview screen for greater visual clarity; fine gauge 20 x 20 fibreglass mesh with wide surround aluminum frame and concealed fasteners.

Glass Preserve™ Protective Film

Removable protective film factory applied to the interior and exterior glass surfaces. Shields the glass from unwanted debris and scratches during shipping, handling and installation. Peels away when the job is complete to reveal clear unblemished glass. A little added insurance for your investment.



Naturally Clean Glass



Neat® Glass : Titanium Dioxide coating applied to the glass that reacts with the sun's UV rays to loosen the bond of organic material to the glass surface. Dirt is easily rinsed away with the rain. The extra smooth surface of Neat Glass sheets the water away promoting faster evaporation and reduces water spotting from residue leaving cleaner, clearer glass.

Specialty Glass

TEXTURED



Obscure



Rain



Hurricane



Glue Chip



Sandblast

TINTED



Bronze



Grey

Contact your Dashwood dealer for these and other custom glass requirements.

Exterior Brickmoulds



1"



1 1/4"

w/ J Channel



1 1/4"



1 1/2"



2"



2 1/2"

w/ J Channel



Sill Nosing w/ End Cap

Grille Options

STANDARD PATTERNS

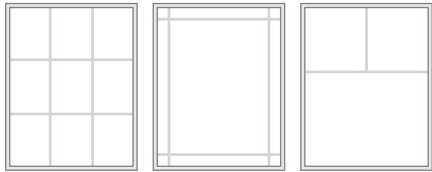

Colonial

Prairie

Craftsman

CUSTOM PATTERNS



Custom Specified Light

Custom Gothic

Custom Renaissance

GRILLE CONSTRUCTION

Internal Grilles Between the Glass (GBG)

Permanently sealed inside the insulating glass for classic appearance and easy cleaning. Choose flat or contoured profiles in widths shown.

GBG PROFILES

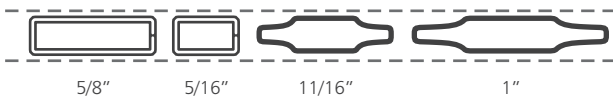

5/8"

5/16"

11/16"

1"

GBG COLOURS



White

Country Almond®

Sandstone

Terrastone

Forest Green

Sandalwood

Red Rock

Charcoal

Dark Brown

Black

Pewter

Brushed Gold

Bright Gold

Top row: available in split & solid colours.
Middle row: available in split.
Bottom row: solid only.

Simulated Divided Light Grilles (SDL)

Applied to the interior and exterior glass surfaces to create an individual divided light look. Add a spacer bar between the glass to replicate an authentic true divided light design while maintaining the energy performance of modern insulating glass.

SDL PROFILES

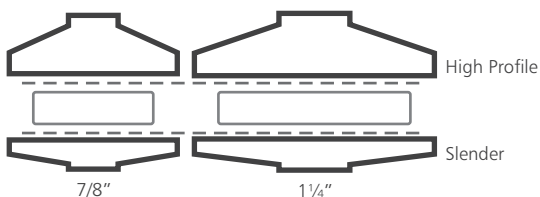

7/8"

1/4"

Interior Options

Interior Jamb Extensions are available in standard 4 5/8", 5 5/8", 6 5/8", 7 7/8" and 10 1/2" dimensions. Custom widths are also available for unique wall conditions.

Clear Pine



Cellular PVC



Finger Jointed Primed Pine

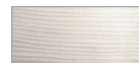

Complete your installation with cellular PVC Interior Trim Casing, popular profiles and widths are available for lineal and curved requirements.

Colours

Trinity windows are offered in 25 exterior finishes. A revolutionary coating specially formulated for vinyl, the finish is designed and tested for superior performance in all environmental conditions to resist peeling, flaking fading and chalking.

STANDARD



DI White

PAINT COLOURS



Sandstone

Sable

Terrastone

Dark Brown

Black

Cloud White

Royal White

Maize

Country Almond

Wicker

Sandalwood

Beige

Canyon Clay

Hickory

Storm

Charcoal

Bahama Brown

Bronze

Old World

Red Rock

Brick Red

Crimson

Cranberry

Colours may not be exactly as shown, contact your dealer for colour samples.

FRAME CONFIGURATION & INSTALLATION

Trinity® Double Hung Insert Installation

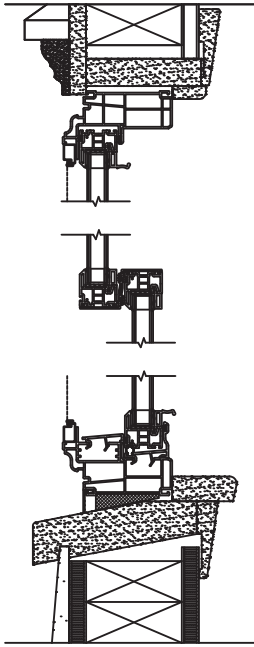

Trinity® Double Hung Full Frame Installation

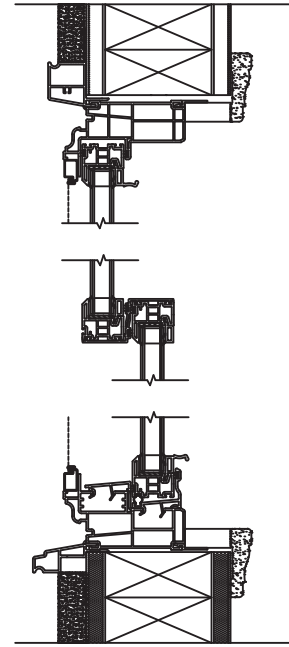

A base frame width of 3-1/4" makes Trinity® ideal for insert installations into an existing window frame.

Optional interior and exterior accessories including jamb extension, trim and brickmould allow Trinity® to be configured for full frame tear-out replacements where the entire old window and trim is removed. Trinity may also be configured for new construction installation.

Trinity® Casement Insert Installation

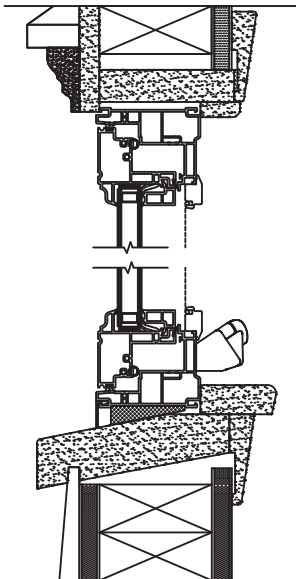

Trinity® Casement Full Frame Installation

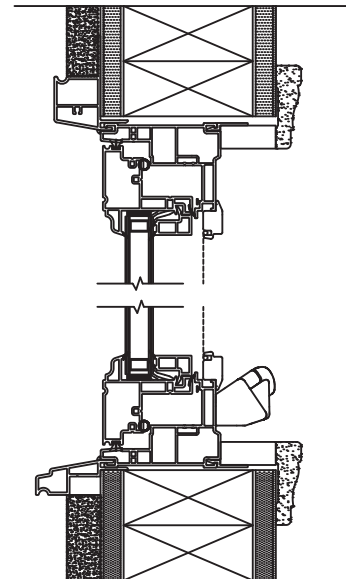



Dashwood Doors

Complete your project with Dashwood doors. Our extensive line of insulated fiberglass and steel entrance doors and hinged terrace doors come with a full selection of options including sidelites, transoms and decorative glass. Silestone vinyl sliding patio doors are available with matching colours and options to complement Trinity® windows. See your Dashwood dealer for details.



WARRANTY

The Dashwood Limited Warranty is among the most comprehensive in the industry:

- Vinyl Limited Lifetime Warranty
- Glass Limited 20 Year Warranty
- Hardware Limited 20 Year Warranty
- Vinyl Coating Limited 20 Year Warranty

Non Prorated and Fully Transferable.

Refer to www.Dashwood.com or call 1-800-265-4284 for full warranty details.

See your dealer for further information.



DASHWOOD INDUSTRIES INC.
69323 Richmond St.,
Centralia, Ontario Canada N0M 1K0
Phone: 519-228-6624
Toll Free: 800-265-4284
Fax: 519-228-2083
www.dashwood.com

PROUDLY
CANADIAN

OWNED &
MANUFACTURED